

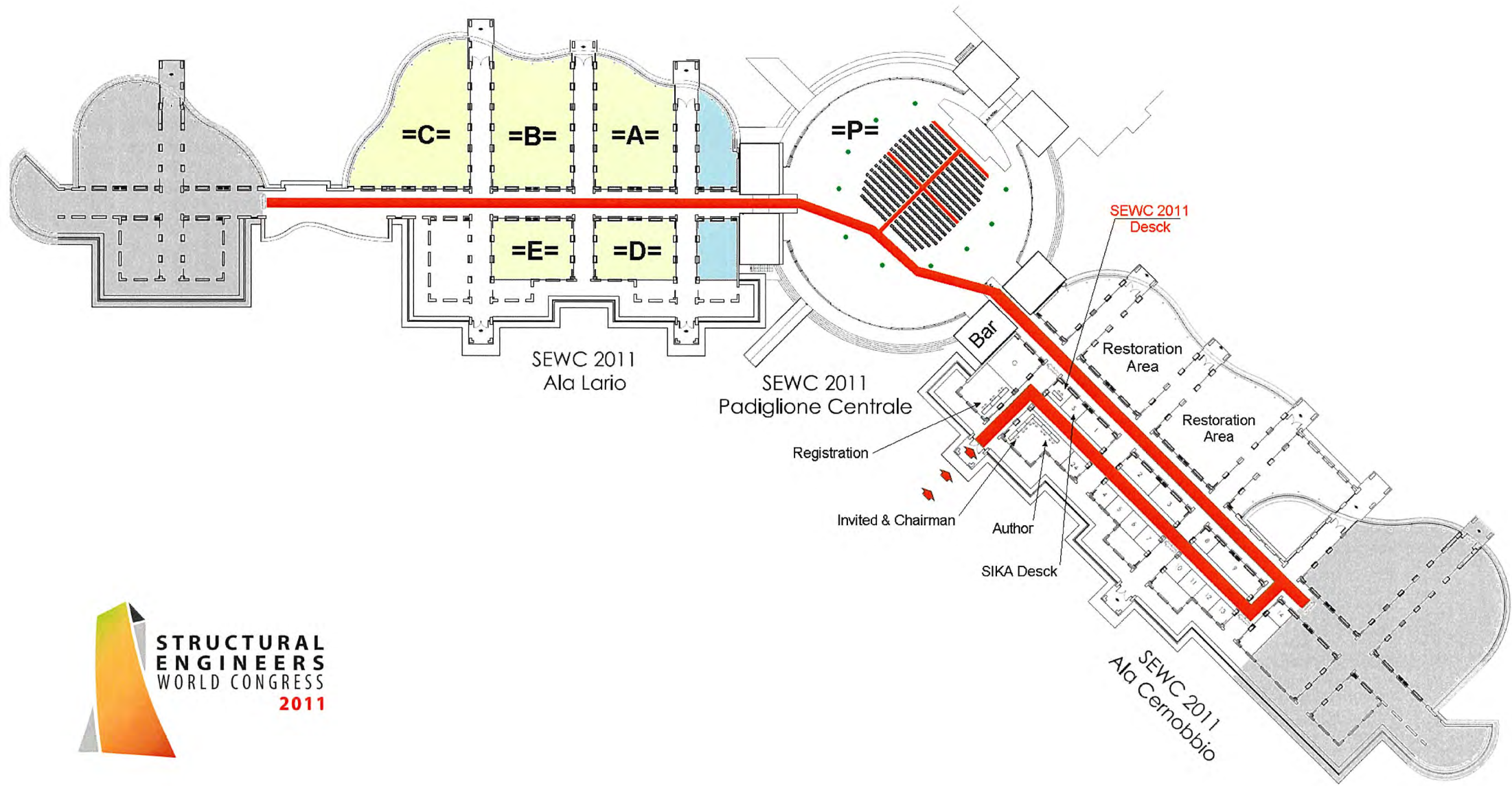

**STRUCTURAL  
ENGINEERS**  
WORLD CONGRESS  
**2011**

# SESSION SCHEDULE



**PLENARY LECTURES**

**APRIL 4TH**

MARTINEZ CALZON, J.	FORMS STRUCTURES AND ENERGY	9:20	9:35
CHIORINO, M.A.	PIER LUIGI NERVI: ARCHITECTURE AS CHALLENGE	9:35	10:00
MOTRO, R.	ART AND STRUCTURAL ENGINEERING – ART OF STRUCTURAL ENGINEERING	10:00	10:25
BURKARD, F.	TBD - ON HISTORY OF CONCRETE ADDITIVES	10:25	10:50
SIVIERO, E.	ENGINEERING VERSUS ARCHITECTURE	14:00	14:25
MAJOWIECKI, M.	STRUCTURES IN ARCHITECTURE	14:25	14:45

**ALUMINIUM STRUCTURES --- SOETENS F. ROOM =D=**

**APRIL 4TH**

VAN DER MEULEN, O.R.	CLASSIFICATION OF ALUMINIUM BEAMS IN FIRE, ANALYTICAL AND EARLY NUMERICAL RESULTS	11:20	11:40
DE MATTEIS, GIANFRANCO	PURE ALUMINIUM HYSTERETIC DEVICES FOR SEISMIC PROTECTION OF BUILDINGS	11:40	12:00
MAZZOLANI, FEDERICO	TWO TWIN ALUMINIUM DOMES OF THE ENEL PLANT	12:00	12:20
VAN HOVE, DIANNE	STRENGTH PROPERTIES OF PINNED CONNECTIONS IN ALUMINIUM TRUSS GIRDERS	12:20	12:40
MANDARA, ALBERTO	THE NEW EUROPEAN CODIFICATION ON ALUMINIUM SHELL BUCKLING	12:40	13:00
STACEY, MICHAEL	ALUMINIUM, ARCHITECTURE AND HUMAN ECOLOGY	14:55	15:15
GIULIANI, GIAN CARLO	THE ALUMINIUM STAIR AND LIFT LOAD-BEARING CORE OF THE BARCELONA AIRPORT TOWER	15:15	15:35

**ARCHINEERING --- FAIRBANKS B. & SAMYN P. ROOM =B=**

**APRIL 4TH**

SAMYN, PHILIPPE		11:20	11:40
SAMYN, PHILIPPE	DREAMS, GENIUS LOCI AND STRUCTURES	11:40	12:00
MELE, ELENA	BUBBLE FRAME: ASSESSMENT OF A NEW STRUCTURAL TYPOLOGY STARTING FROM THE WATER CUBE	12:00	12:20
YANG, BIN	APPLYING A PARALLEL PARTICLE SWARM OPTIMIZER TO TRUSS TOPOLOGICAL DESIGN	12:20	12:40
TROMBETTI, TOMMASO	ARCHINEERING? ENGISTAR? WHICH NAME FOR THE BIRTH OF AN ENGINEERING CULTURE?	12:40	13:00
FAIRBANKS, BRUCE		14:55	15:15
FAIRBANKS, BRUCE	STRUCTURE AND THE ARCHITECTURAL CONCEPT	15:15	15:35
ARIAS, RUBEN	GEOMETRIC DESIGN OF PATCHED SPATIAL STRUCTURES VIA WRD	15:35	15:55
JAISIM, K	ARCHITECTURAL ENGINEERING - AN INTEGRATION OF ART AND TECHNOLOGY	15:55	16:15

<b>CONCRETE COMPOSITES --- POGGI C. ROOM =C=</b>		<b>APRIL 4TH</b>	
WATANABE, SEIICHI	RESEARCH ON ADHESIVE STRENGTH OF CONCRETE PLACING JOINT PLANE	14:50	15:10
RAO TIPPABHOTLA, D.G.	HIGH STRENGTH SFRC: PURE TORSION	15:10	15:30
ALMERICH CHULIA, ANA I	DEVELOPMENT AND APPLICATIONS OF GLASS FIBER BARS AS A FRAME IN CONCRETE STRUCTURES	15:30	15:50
OGASAWARA, TETSUYA	STRENGTHENING TECHNIQUE OF THE MARINE PIER BEAM BY DFRCC	15:50	16:10
SRIMAN NARAYAN, HN	FRACTURE ENERGY OF FIBER REINFORCED HIGH STRENGTH CONCRETE BEAMS	16:45	17:05
CHI, TONY	THE DEVELOPMENT OF PRECAST CONCRETE TECHNIQUES - TECHNOLOGIES IN SOUTHEAST ASIA & ASIA	17:05	17:25
<b>CONCRETE TECHNOLOGY --- BIANCHI F. &amp; PALOMBA S. ROOM =C=</b>		<b>APRIL 4TH</b>	
BAMAGA, SALEH	STRENGTH AND CHLORIDE RESISTANCE OF CONCRETE CONTAINING PALM OIL FUEL ASH	11:20	11:40
KATAKALOS, KONSTANTINOS	INVESTIGATION OF TWO DIFFERENT ANCHORING DEVICES AND THEIR INFLUENCE ON CONCRETE SURFACE TREATMENT WHEN EITHER CFRP OR SRP ARE BEING APPLIED FOR STRENGTHENING R/C STRUCTURAL MEMBERS	11:40	12:00
ARUNACHALAM, K	EXPERIMENTAL INVESTIGATION OF ULTRA HIGH STRENGTH CONCRETE	12:00	12:20
VISHWANATHAN, S	QUALITY IMPROVEMENT IN CONCRETE MAKING PROCESS	12:20	12:40
RAMACHANDRA, V	WHITETOPPING OF ROADS – A CASE STUDY	12:40	13:00
<b>FIRE ENGINEERING --- CAJOT L.G. &amp; GAMBAROVA P. ROOM =D=</b>		<b>APRIL 4TH</b>	
GAMBAROVA, PIETRO	FIRE ENGINEERING	16:45	17:05
CLEMENT, FRANK	IMPACT OF A FIRE ON STRUCTURAL CONCRETE	17:05	17:25
ZANON, RICCARDO	NEW ANALYTICAL MODEL FOR THE CALCULATION OF STEEL COLUMNS SUBJECTED TO LOCALISED FIRE	17:25	17:45
PUSTORINO, SANDRO	PERFORMANCE-BASED FIRE SAFETY APPROACH – APPLICATION TO OPEN CAR PARKS ACCORDING TO THE NEW ITALIAN REGULATION	17:45	18:05
ZANON, RICCARDO	ANALYSIS OF STEEL-FRAMED OPEN CAR PARKS UNDER LOCALISED FIRE	18:05	18:25

<b>HIGH RISE BUILDINGS --- GIULIANI M.E. &amp; LAGOS R. ROOM =A=</b>		<b>APRIL 4TH</b>	
PRAKASH, SURYA	TALL COMMUNICATION TOWERS - RETROFITTING AND STABILITY CONSIDERATIONS	11:20	11:40
MEHROTRA, SC	EARTHQUAKE RESISTANT DESIGN AND CONSTRUCTION OF BUILDINGS IN INDIA	11:40	12:00
TORENO, MAURIZIO	AN OVERVIEW ON DIAGRID STRUCTURES FOR TALL BUILDINGS	12:00	12:20
SUN MOON, KYOUNG	DIAGRIDS FOR STRUCTURAL DESIGN AND CONSTRUCTION OF COMPLEX-SHAPED TALL BUILDINGS	12:20	12:40
HIRAKAWA, KIYOAKI	PERFORMANCE BASED DESIGN APPROACH TO 300 METER HIGH TOWER BUILDING	12:40	13:00
XUE, WANLI	DYNAMIC ELASTO-PLASTIC TIME-HISTORY ANALYSIS FOR OUT-OF-CODES HIGH-RISE STRUCTURE	14:55	15:15
KIM, YONG-KU	PINNACLE LIFT-UP OF BURJ KHALIFA	15:15	15:35
RYANG CHUNG, KWANG	EFFECT OF HIGH-STRENGTH STEEL FOR SUPER TALL BUILDING	15:35	15:55
DE ANGELIS/VESE ,	HIGH RISE BUILDINGS.SEQUENTIAL LOADING AND LONG TERM EFFECTS ON VERTICAL SHORTENING	15:55	16:15
GIULIANI, MAURO EUGENIO	HADID TOWER IN MILANO: A TORSION RESISTING STRUCTURE	16:45	17:05
CAPSONI, FABIO	HADID TOWER IN MILANO - DIMENSIONING AND ANALYSIS OF THE STRUCTURES	17:05	17:25
RAGHU PRASAD, BK	EARTHQUAKE AND WIND EFFECTS ON TALL OVERHEAD WATER TANK	17:25	17:45
<b>REHABILITATION &amp; REPAIR --- BINDA L. ROOM =B=</b>		<b>APRIL 4TH</b>	
EL-MAADDAWY, TAMER	INVESTIGATION INTO THE PERFORMANCE OF CONCRETE BEAMS WITH RECTANGULAR OPENINGS STRENGTHENED IN SHEAR WITH CFRP COMPOSITES	16:45	17:05
GARAVAGLIA, ELSA	MODELLING OF THE DAMAGE EVOLUTION OVER TIME OF JOINTS AND MORTAR/BRICK INTERFACES UNDER SALT CRYSTALLISATION TESTS	17:05	17:25
BANSAL, DEEPAK	DRY STACKED INTERLOCKING BLOCK MASONRY-SUSTAINABLE & STRUCTURALLY VIABLE OPTION	17:25	17:45
MEDA, ALBERTO	REPAIR AND STRENGTHENING OF REINFORCED CONCRETE COLUMNS AND BEAMS WITH VERY LOW THICKNESS OF HIGH PERFORMANCE FIBER REINFORCED CEMENTITIOUS COMPOSITES COMPLYING TO THE STRUCTURAL ANTISEISMIC REINFORCEMENT PROJECT	17:45	18:05
MORANDINI, GIULIO	EXPERIMENTAL CAMPAIGN ON TUFF MASONRY STRENGTHENED WITH FRG	18:05	18:25
<b>WIND ENGINEERING --- SOLARI G. ROOM =E=</b>		<b>APRIL 4TH</b>	
SOLARI, GIOVANNI	NEW CHALLENGES IN WIND-INDUCED FATIGUE OF STRUCTURES	16:45	17:05
DOMANESCHI, MARCO	SEMI-ACTIVE SYSTEMS FOR THE WIND EFFECTS MITIGATION OF A SUSPENSION BRIDGE	17:05	17:25
LIU, HUIQUN	THE AMBIENT EXCITATION TESTING AND SIMULATION OF THE NATURAL VIBRATION CHARACTERISTICS OF TRANSMISSION LINE	17:25	17:45
XIN, ZHAO	WIND ENGINEERING AND STRUCTURAL DESIGN OF SHANGHAI TOWER	17:45	18:05
VIDYASHANKAR, HOSKERE	WIND DESIGN CONSIDERATIONS FOR TALL WATER TOWERS	18:05	18:25

<b>WOOD STRUCTURES --- FRAGIACOMO M.</b>		<b>ROOM =E=</b>	<b>APRIL 4TH</b>	
TLUSTOCHOWICZ, GABRIELA	PREFABRICATED STABILISING WALLS FOR MULTI-STOREY TIMBER BUILDINGS - GENERAL CONCEPTS AND PRELIMINARY DESIGN		11:20	11:40
VAN BEERSCHOTEN, WOUTER	EXPERIMENTAL INVESTIGATION ON THE STIFFNESS OF BEAM-COLUMN CONNECTIONS IN POST-TENSIONED TIMBER FRAMES		11:40	12:00
TOMASI, ROBERTO	EXPERIMENTAL INVESTIGATION ON CONNECTIONS BETWEEN WOOD FRAMED SHEAR WALLS AND FOUNDATIONS		12:00	12:20
TOMASI, ROBERTO	EXPERIMENTAL INVESTIGATION OF THE BEHAVIOUR OF DIFFERENT TYPE OF CONNECTIONS BETWEEN THE XLAM PANELS AND THE CONCRETE SLAB		12:20	12:40
SARTI, FRANCESCO	SIMPLIFIED DESIGN TOOLS FOR POST-TENSIONED TIMBER BEAMS AND WALLS		12:40	13:00
CRISTINI, TIZIANA	POST-TENSIONING IN TIMBER SLABS		14:55	15:15
PALERMO, ALESSANDRO	APPLICATION OF POST-TENSIONING TECHNIQUES TO PEDESTRIAN TIMBER BRIDGES		15:15	15:35
VALDEZ-CHACON, ROBERTO	EXPERIMENTAL STUDY OF WALLS OF BLOCKS UNDER LATERAL LOADS		15:35	15:55
GIULIANI, GIAN CARLO	A WOODEN RETRACTABLE LAMELLA ROOF		15:55	16:15

<b>PLENARY LECTURES</b>		<b>APRIL 5TH</b>	
PANZA, G.	SCENARIO BASED TIME DEPENDENT DEFINITION OF SEISMIC INPUT	8:30	8:55
GOEPPERT, K.	NEW STADIUM STRUCTURES	8:55	9:20
BELLINI, M.	STRUCTURAL ENGINEERING OF ARCHITECTURE AND ARCHITECTURAL LANGUAGE OF STRUCTURES	14:20	14:45
STRASKY, J.	RECENT DEVELOPMENTS IN DESIGN OF STRESS RIBBON PEDESTRIAN BRIDGES	14:45	15:10
<b>ANALYSIS --- MAIER G. ROOM =E=</b>		<b>APRIL 5TH</b>	
BELLMANN, JUERGEN	NONLINEAR HALFSPACE CONTACT	9:25	9:45
ESLAMI, HASHEM	MATHEMATICAL SOLUTION FOR WAVE DIFFRACTION BY A CYLINDRICAL INCLUSION IN TRANSVERSELY ISOTROPIC MEDIA	9:45	10:05
SULLIVAN, TIM	DEVELOPMENT OF DIRECT DISPLACEMENT BASED DESIGN SOFTWARE	10:05	10:25
CÁRDENAS, SELENE	LIMIT ANALYSIS OF RIGID BLOCK MODELS FOR REINFORCED CONCRETE FRAMES UNDER LATERAL LOADS	10:25	10:45
LIANG, HUANG	A QUANTIFICATION METHOD OF STRUCTURAL ROBUSTNESS	10:45	11:05
WANG, XIAO	A NEW SPATIAL BEAM ELEMENT WITH CLOSED THIN-WALLED SECTION	11:35	11:55
WANG, ZHONGQUAN	A STATIC RELAXATION ALGORITHM FOR MOTION-DEFORMATION ANALYSIS OF CONSTRUCTION SIMULATION	11:55	12:15
HÜLYA ÇALIK KARAKÖSE, ÜLKÜ	BUCKLING ANALYSIS OF BUILT-UP AND COMPOSITE COLUMNS USING EQUIVALENT HOMOGENEOUS FRAME MEMBERS	12:15	12:35
<b>BRIDGES --- STRASKY J. ROOM =B=</b>		<b>APRIL 5TH</b>	
SIVIERO, ENZO	BRIDGES AND ARCHITECTURE DESIGN ISSUES AND CONSTRUCTION METHOD OF A NEW CONCRETE RAILWAY BRIDGE OVER THE SWISS A2 MOTORWAY IN CAMORINO (ALPTRANSIT LOT 771)	15:15	15:35
ROSSI, FRANCESCO		15:35	15:55
RIZZI, EGIDIO	FEM MODELLING OF THE PADERNO D'ADDA BRIDGE (ITALY, 1889)	15:55	16:15
CHEN, AIRONG	WAVE INDUCED VIBRATION ANALYSIS OF A STEEL CURVED BRIDGE CONSIDERING SCOURING EFFECT	16:15	16:35
WANG, REN-ZUO	EXPERIMENTAL AND NUMERICAL ANALYSIS OF A BRIDGE FOR HIGH-SPEED TRAINS	16:35	16:55
SU, QINGTIAN	EFFECTIVE WIDTH OF CONTINUOUS COMPOSITE GIRDER OF ARCH BRIDGE	17:25	17:45
RECCIA, EMANUELE	MULTI-SCALE ANALYSIS OF VENICE TRANS-LAGOON BRIDGE	17:45	18:05
GIULIANI, MAURO EUGENIO	RECENT LANDMARK BRIDGES IN ALGERIAS	18:05	18:25

<b>CONCRETE THEORY 1 --- CHIORINO M.A. &amp; MÜLLER H. ROOM =B=</b>		<b>APRIL 5TH</b>	
CHIORINO, MARIO A.	ANALYSIS OF STRUCTURAL EFFECTS OF TIME DEPENDENT BEHAVIOR OF CONCRETE: AN INTERNATIONALLY HARMONIZED FORMAT EVALUATION AND COMPARISON OF THE ANALYTICAL MODELS TO PREDICT CREEP AND SHRINKAGE BEHAVIOUR OF SELF-COMPACTING CONCRETE	9:25	9:45
ASLANI, FARHAD		9:45	10:05
CHOI, IN-RAK	CREEP EFFECTS IN CONCRETE-FILLED STEEL TUBE COLUMNS WITH HIGH-STRENGTH STEEL AND CONCRETE	10:05	10:25
GRANDIC, DAVOR	DEFLECTION OF REINFORCED CONCRETE BEAMS SIMULTANEOUSLY SUBJECTED TO SUSTAINED LOAD AND REINFORCEMENT CORROSION	10:25	10:45
LI, WENCONG	HYSTERESIS RESPONSE OF EXTERIOR BEAM-COLUMN JOINTS WITH SELF-CENTERING BEHAVIOR	10:45	11:05
LIANG, HUANG	CYCLIC BEHAVIOR OF HIGH-REDUNDANCY REINFORCED CONCRETE WALLS	11:30	11:48
PANTOJA, JOÃO	THE IMPACT OF UNCERTAINTIES MODEL CONSIDERED IN RELIABILITY ANALYSIS OVER THE DESIGN OF REINFORCED CONCRETE DEEP BEAMS BY STRUT-AND-TIE MODEL.	11:48	12:06
CASALEGNO, CARLO	TIME-DEPENDENT EFFECTS IN CONCRETE STRUCTURES: A GENERAL COMPUTATIONAL APPROACH	12:06	12:24
MOLA, FRANCO	NEW THEORETICAL ASPECTS IN LINEAR VISCOELASTIC ANALYSIS OF CONCRETE STRUCTURES	12:24	12:42
KVITSEL/MÜLLER ,	CREEP AND SHRINKAGE OF HIGH PERFORMANCE LIGHTWEIGHT AGGREGATE CONCRETE	12:42	13:00
<b>CONCRETE THEORY 2 --- MOLA F. ROOM =E=</b>		<b>APRIL 5TH</b>	
MOLA, FRANCO	CONCEPTUAL APPROACH AND ANALYSIS IN THE STRUCTURAL DESIGN OF RC TALL BUILDINGS	15:15	15:35
OKA, HIDEO	LIGHTWEIGHT SANDWICH SLABS CONSISTING OF AN ALC CORE ADHESIVELY BONDED WITH STEEL SKINS	15:35	15:55
LANG, CHRISTIAN	NATURAL DRAFT COOLING TOWER DESIGN AND CONSTRUCTION IN GERMANY - PAST (SINCE 1965), PRESENT AND FUTURE	15:55	16:15
VALENTE, MARCO	SEISMIC PERFORMANCE AND RETROFITTING OF PRECAST INDUSTRIAL BUILDINGS	16:15	16:35
MOLA, FRANCO	EFFECTS OF COLUMN SHORTENING IN R.C. TALL BUILDINGS	17:25	17:45
MORO, S.	ULTRA HIGH PERFORMANCE CONCRETE: FROM MATERIAL OPTIMIZATION TO STRUCTURAL APPLICATIONS	17:45	18:05
CHOWDHURY, SHARMIN	ANALYTICAL MODELING OF BOND SLIP RESPONSES IN REINFORCED CONCRETE COLUMNS	18:05	18:25
YONAMINE, HITOSHI	HOTO FUDO - HOLISTIC DESIGN OF A SANDWICH RC SHELL STRUCTURE -	18:25	18:45
<b>FORM FINDING --- MAJOWIECKI M. ROOM =C=</b>		<b>APRIL 5TH</b>	
GROHMANN, MANFRED	FORM FINDING OF THE SPHERE AT THE DEUTSCHE BANK HEADQUARTERS IN FRANKFURT, GERMANY	15:15	15:35
BOBER, WALDEMAR	SPACE STRUCTURES FROM APERIODIC PATTERNS – APPLICATION OF AMMANN BAR GRIDS CONCEPT	15:35	15:55
TARCZEWSKI, ROMUALD	GENERATION OF STRUCTURAL LATTICES BY MEANS OF MULTIPLICATION OF PLANAR GRAPHS	15:55	16:15
GRANATA, MICHELE FABIO	STRUCTURAL IMPLICATIONS IN FIUMARA D'ARTE PYRAMID	16:15	16:35
PARIGI, DARIO	MORPHOGENESIS OF KINETIC RECIPROCAL FRAMES	16:35	16:55



**LIGHTWEIGHT STRUCTURES --- OBREBSKI J. & SAITOH M.**

**ROOM =D=**

**APRIL 5TH**

OBREBSKI, JAN	LIGHTWEIGHT STRUCTURES - FROM THEORY TO DESIGN	9:25	9:45
QIAO, LEI	ANALYSIS AND DESIGN OF LONG-SPAN CABLE- MEMBRANE STRUCTURES INTEGRATED WITH SUPPORTED STRUCTURE	9:45	10:05
KIDO, TAKAHIRO	DESIGN AND CONSTRUCTION OF THE COMPLEX-BEAM STRING STRUCTURE	10:05	10:25
SUZUKI, MINORU	RECENT EXAMPLES OF CABLE STRUCTURES -DESIGN AND CONSTRUCTION FOCUSED ON INITIAL TENSILE FORCE-	10:25	10:45
HIDEKI, TABATA	CONSTRUCTION OF TENSION STRUCTURES BASED ON THE ERECTION PROCESS ANALYSIS	10:45	11:05
SAITOH, MASAO	CONCEPTUAL DESIGN OF HYBRID STRING STRUCTURES	11:35	11:55
KIMURA, SEIGO	A STRUCTURAL DESIGN OF TWO-WAY, SINGLE LAYER LATTICED DOME	11:55	12:15
STOBIECKI, PRZEMYSŁAW	A SPECIAL CASE OF A NON-DEVELOPABLE SURFACE AND ITS APPLICATIONS	12:15	12:35
REICHHART, ADAM	DESIGNING OF SHELL SHAPED ROOFS MADE OF PROFILED SHEETS	12:35	12:55

**SEISMIC ENGINEERING --- MEDEOT R.**

**ROOM =A=**

**APRIL 5TH**

ESER, MUBERRA	SOIL STRUCTURE INTERACTION EFFECTS ON RESPONSE OF MULTISTOREY STRUCTURES	11:35	11:55
TANIGUCHI, YOSHIYA	SEISMIC MOTION LEVEL OF DYNAMIC COLLAPSE OR LIMIT STATE DEFORMATION FOR LATTICE ARCH AND CYLINDRICAL ROOF	11:55	12:15
SOMMAVILLA, MAURO	INERD SOFTWARE: A NEW DESIGN TOOL TO IMPROVE THE ROBUSTNESS OF RCMRF UNDER EARTHQUAKE LOADING	12:15	12:35
BAIRD, ANDREW	NUMERICAL MODELLING OF LOCAL CLADDING-STRUCTURE INTERACTION	12:35	12:55
DIAFERIA, RICCARDO	NUMERICAL STUDY ON THE SEISMIC INTERACTION BETWEEN 2D SEISMIC RESISTING FRAMES AND CLADDINGS	12:55	13:15
YAMAGA, NOBUHIDE	DESIGN OF HIGH-RISE BASE ISOLATED STRUCTURE WITH A COMPLEX SHAPE AND LONG SPAN	15:15	15:35
IKEDA, KOTARO	INFLUENCES OF CHANGING RIGIDITY CENTER WITH VIBRATION ON EARTHQUAKE RESISTANCE OF THE STEEL FRAME WITH DIFFERENT HYSTERESIS MODEL	15:35	15:55
PAGANOTTI, GIACOMO	DEVELOPMENT OF TYPICAL CEILING SYSTEM SEISMIC FRAGILITIES	15:55	16:15
BIONDINI, FABIO	ON THE ACCURACY OF RESPONSE SPECTRUM ANALYSIS IN SEISMIC DESIGN OF CONCRETE STRUCTURES	16:15	16:35
NOGUCHI, HIROSHI	ANALYTICAL STUDY ON EARTHQUAKE RESISTANCE OF ULTRA HIGH STRENGTH REINFORCED CONCRETE COLUMNS CONTAINING STEEL FIBER	16:35	16:55
POLYCARPOU, PANAYIOTIS	NUMERICAL INVESTIGATION OF STRUCTURAL POUNDING OF SEISMICALLY ISOLATED BUILDINGS DURING STRONG EARTHQUAKES	17:25	17:45
MUSTAFY, TANVIR	SEISMIC RESPONSE ANALYSIS OF BRIDGE WITH DIFFERENT ISOLATORS	17:45	18:05
TIAN, JIE	STUDY ON NONLINEAR EARTHQUAKE RESPONSE OF RC FRAME AND STEEL PLATE SHEAR WALL	18:05	18:25
MORITA, AKIRA	STRUCTURAL DESIGN OF SPACE STRUCTURES CONSIDERING DYNAMIC FORCES	18:25	18:45

**STADIA --- GOEPPERT K.**

**ROOM =A=**

**APRIL 5TH**

WATANABE, TOMOHIRO	STRUCTURAL DESIGN OF STADIUM ROOF IN JAPAN AND CHINA	9:25	9:45
KIM, JONG-HO	STRUCTURAL DESIGN OF THE STADIUM IN KOREA - YONGIN CITIZEN SPORTS PARK	9:45	10:05
JIEMIN, DING	RECENT APPLICATIONS AND PRACTICES OF ROOF STEEL STRUCTURE OF STADIUMS IN CHINA	10:05	10:25

<b>STEEL STRUCTURES --- ZHANG Q. ROOM =C=</b>		<b>APRIL 5TH</b>	
ZHANG	STEEL STRUCTURES	9:25	9:45
GOWDA, BHARATH	NEW BOLTED SPACEFRAME SYSTEM	9:45	10:05
DUTHINH, DAT	A SIMPLIFIED LINEAR MODEL FOR GUSSET PLATE CONNECTIONS	10:05	10:25
GERBER, BRIAN	ACCEPTANCE CRITERIA FOR STEEL DECK FLOOR AND ROOF SYSTEMS TO SHOW COMPLIANCE WITH THE INTERNATIONAL BUILDING CODE	10:25	10:45
IMABAYASHI, MITSUhide	ROOF STRUCTURE BETWEEN TWO BUILDINGS IN SEVERE EARTHQUAKE PRONE COUNTRY	10:45	11:05
JIEMIN, DING	PRELIMINARY DESIGN OF THE STEEL ROOF STRUCTURE FOR A RAILWAY STATION	11:35	11:55
TASAKA, MASANORI	A LONG SPANNING STEEL ROOF DESIGN IN VIETNAM	11:55	12:15
JEON, BONG-SOO	DESIGN AND CONSTRUCTION OF 85M CANTILEVERED ROOF OF THE BUSAN CINEMA CENTRE, REP. OF KOREA	12:15	12:35
BECCI, BRUNO	INSTALLING AN AUTOMATIC OVERHEAD CRANE IN COMPLEX CONDITIONS	12:35	12:55
LIANG, FENG	BEARING CAPACITY AND FATIGUE PERFORMANCE OF REVERSE BALANCE FLANGE IN WIND TURBINE TOWE	12:55	13:15
KRSTICH, MISHO	MODULARIZATION,WHY,WHERE,HOW?	17:25	17:45
BONESCHI, VITTORIO	STAINLESS STEEL: A STRUCTURAL ANTI-SEISMIC AND FIRE RESISTANT MATERIAL	17:45	18:05
RAMASWAMY, MS	DESIGN OF A LARGE SPAN TRUSS USING COLD FORMED STEEL SECTIONS	18:05	18:25
THANABAL, K.	USE OF ALTERNATIVE STEEL IN BS5950 DESIGN	18:25	18:45
<b>TENSEGRITY --- MOTRO R. ROOM =D=</b>		<b>APRIL 5TH</b>	
GOMEZ-JAUREGUI,V.	NEW CONFIGURATIONS FOR DOUBLE-LAYER TENSEGRITY GRIDS	15:15	15:35
RHODE-BARBARIGOS,L.	DEPLOYMENT ASPECTS OF A TENSEGRITY-RING PEDESTRIAN BRIDGE	15:35	15:55
TIBERT, GUNNAR	DESIGN AND FORM-FINDING ANALYSIS OF TENSEGRITY POWER LINES	15:55	16:15
DALILSAFAEI, SEIF	APPLICATION OF FLEXIBILITY ANALYSIS FOR DESIGN OF TENSEGRITY STRUCTURES	16:15	16:35
JÉRÔME, QUIRANT	MECHANICAL BEHAVIOUR OF A FOLDABLE TENSEGRITY RING: PARAMETRIC STUDY	16:35	16:55
FISEL, DOMINIK	PROPOSITION OF AN INDEX DESCRIPTION SYSTEM FOR GEOMETRIC AND MECHANICAL PROPERTIES OF SPATIAL TENSEGRITY STRUCTURES	17:25	17:45
AVERSENG, JULIEN	INTERACTIVE DESIGN AND DYNAMIC ANALYSIS OF TENSEGRITY SYSTEMS	17:45	18:05
MICHELETTI, ANDREA	STRUCTURAL PERFORMANCES OF SINGLE-LAYER TENSEGRITY DOMES	18:05	18:25
BINIENIEK, ZBIGNIEW	CHOSEN IDEAS OF GEOMETRICAL SHAPING OF MODULAR TENSEGRITY STRUCTURES	18:25	18:45
YOSHINO, SEIICHI	FROM ARCHITECTURE TO THE TABLE – DESIGN AND FABRICATION OF TENSEGRITY STRUCTURE	18:45	19:05

<b>PLENARY LECTURES</b>		<b>APRIL 6TH</b>	
LAGOS, R.	PERFORMANCE OF HIGH RISE BUILDINGS	8:30	8:55
MAIER, G.	DIAGNOSES OF STRUCTURES BY INVERSE ANALYSIS	8:55	9:20
KRAETZIG, W.B.	SOLAR UPDRAFT POWER PLANTS AND SOLAR CHIMNEYS	14:10	14:35
GIULIANI, M.E.	ABOUT STRUCTURAL DETAILS	14:35	14:35
<b>ASSESSMENT &amp; RETROFIT --- MURTHY K. ROOM =B=</b>		<b>APRIL 6TH</b>	
KANEBAKO, YOSHIHARU	SEISMIC RETROFIT DESIGN WITH THE STEEL FRAMES INTEGRATED STRUCTURAL ELEMENT AND FACADE DESIGN	9:25	9:45
CAGNAN, ZEHRA	COMPUTER MODELLING AND SEISMIC PERFORMANCE ASSESSMENT OF A GOTHIC CATHEDRAL IN CYPRUS	9:45	10:05
CAUSEVIC, AMIR	EVALUATION OF STABILITY OF SACRAL AND HISTORICAL TOWERS DEPENDING ON SEISMIC ZONE	10:05	10:25
PALERMO, MICHELE	THE INFILLS EFFECTS ON THE SEISMIC BEHAVIOR OF R.C. STRUCTURES: A CASE STUDY ON A BUILDING IN L'AQUILA, ITALY	10:25	10:45
IHSAN UNAY, ALI	ASSESSMENT OF SEISMIC RESISTANCE OF SURP NIGOGOYAS CHURCH UNDER EARTHQUAKE	10:45	11:05
VAF AEI, MOHAMMADREZA	REAL-TIME SEISMIC DAMAGE DETECTION OF FOUNDATIONS USING ARTIFICIAL NEURAL NETWORKS	11:30	11:50
HSIAO, FU-PEI	VERIFICATION OF SEISMIC EVALUATION FOR RC SCHOOL BUILDINGS	11:50	12:10
ZENG, MINGGEN	ANALYSIS ON SUSPENDER REPLACEMENT PLAN OF THE TIED ARCH BRIDGE	12:10	12:30
RATNAVEL, SANNA	DISTRESSED BUILDINGS IN SOUTH INDIA - A CASE STUDY	12:30	12:50
MURTHY, KESHAVA	"KEY" TO STRUCTURAL HEALTH OF BUILDINGS	12:50	13:10
<b>DYNAMICS - DEVICES --- MARTELLI A. ROOM =A=</b>		<b>APRIL 6TH</b>	
MARTELLI, A.	RECENT WORLDWIDE APPLICATION OF SEISMIC ISOLATION AND ENERGY DISSIPATION AND CONDITIONS FOR THEIR CORRECT USE	9:25	9:45
WATANABE, TETSUMI	APPLICATION OF ACTIVE BASE ISOLATION SYSTEM USING ABSOLUTE VIBRATION CONTROL TECHNOLOGY	9:45	10:05
NISHIMURA, ISAO	BASE ISOLATION OF LIGHTWEIGHT STRUCTURE BY LAMINATED RUBBER BEARINGS	10:05	10:25
BIANCHI, GIORGIO	HIGH DAMPING RUBBER BEARING (HDRB) ISOLATING DEVICES FOR NUCLEAR POWER PLANTS: FE MODELLING AND DAMAGE/FAILURE CHARACTERIZATION	10:25	10:45
WEISZ, GABRIELE	SHOCK TRANSMITTERS APPLICATION TO A REINFORCED CONCRETE PRECAST BUILDING	10:45	11:05
MEDEOT, RENZO	EXPERIMENTAL VALIDATION OF THE RE-CENTRING CAPABILITY EVALUATION METHOD ADOPTED IN THE EUROPEAN STANDARD ON ANTI-SEISMIC DEVICES	11:30	11:50
MORITA, KEIKO	LONG-TERM PERFORMANCE TEST OF LAMINATED RUBBER BEARING FOR SEISMIC ISOLATION SYSTEM	11:50	12:10
AIDA, HIROMASA	EVALUATION OF THE VIBRATION CONTROL PERFORMANCE BASED ON VIBRATION TEST FOR ACTUAL BUILDINGS WITH OIL DAMPER	12:10	12:30
TOMIZAWA, TETSUYA	CONSTRUCTION OF CIVIL BUILDING USING THREE-DIMENSIONAL SEISMIC ISOLATION SYSTEM	12:30	12:50
VALENTE, MARCO	BRACED DUCTILE SHEAR PANEL: A NEW SEISMIC RESISTANT FRAMING SYSTEM	12:50	13:10

<b>DYNAMICS - DEVICES --- MARTELLI A. ROOM =A=</b>		<b>APRIL 6TH</b>	
HUBER, PETER	CHARACTERISTICS OF CURVED SURFACE SLIDING ISOLATORS FOR SERVICE AND SEISMIC LOAD CASES	15:05	15:25
GABRIELLA CASTELLANO, MARIA	TESTING OF ELASTOMERIC ISOLATORS FOR NUCLEAR POWER PLANTS	15:25	15:45
X.Q., LUO	DAMAGE CONTROL STUDY FOR SPATIAL TRUSS STRUCTURES USING BRBS UNDER STRONG EARTHQUAKES	15:45	16:05
USTUNDAG, CENK	STUDIES ON THE DESIGN AND APPLICATION OF SPHERICAL AND ELASTOMERIC BEARINGS SUBJECTED TO COMPRESSION AND UPLIFT FORCES	16:05	16:25
MAALEK, SHAHROKH	THE PRESENTATION OF A CIRCULAR PASSIVE ENERGY DISSIPATION DEVICE FOR USE IN STEEL BRACED FRAMES	16:25	16:45
<b>GLASS --- TBD ROOM =D=</b>		<b>APRIL 6TH</b>	
GOVINDARAJAN, JANAKIRAMAN	DEVELOPMENTS OF GLASS IN ARCHITECTURAL AND STRUCTURAL APPLICATIONS	9:25	9:45
VIDAL MAORAL, ALBERT	CAN GLASS COMPETE WITH ACRYLICS IN LARGE AQUARIUM ENCLOSURES ?	9:45	10:05
GUITART, NÚRIA	COMPOSITE STEEL-GLASS FINS FOR THE LOBBY FAÇADE OF IBERDROLA TOWER	10:05	10:25
GIULIANI, GIAN CARLO	A WIDE SPAN GLAZED ROOF IN A SEISMIC AREA	10:25	10:45
<b>REHABILITATION &amp; REPAIR --- BINDA L. ROOM =D=</b>		<b>APRIL 6TH</b>	
DA PORTO, FRANCESCA	NEW INTEGRATED KNOWLEDGE BASED APPROACHES TO THE PROTECTION OF CULTURAL HERITAGE FROM EARTHQUAKE-INDUCED RISK	15:05	15:25
VALENTE, MARCO	SEISMIC RETROFITTING STRATEGIES FOR AN UNDER-DESIGNED R/C STRUCTURE	15:25	15:45
CARDANI, GIULIANA	METHODOLOGY FOR ON SITE EVALUATION OF PHYSICAL AND MECHANICAL PROPERTIES OF HISTORIC MASONRY	15:45	16:05
LORENZONI, FILIPPO	THE SPANISH FORTRESS IN L'AQUILA: EMERGENCY ACTIONS, INVESTIGATIONS AND MONITORING	16:05	16:25
<b>SPECIAL CONCRETE STRUCTURES --- GIULIANI G.C. &amp; SUNDARAM R. ROOM =B=</b>		<b>APRIL 6TH</b>	
BOLLINGER, KLAUS	FORM FINDING FOR THE ROLEX LEARNING CENTER AT EPFL LAUSANNE	15:05	15:25
BOLLINGER, KLAUS	CONSTRUCTION OF THE ROLEX LEARNING CENTER AT EPFL LAUSANNE	15:25	15:45
SUNDARAM, R.	CONCRETE SHELL ROOFS	15:45	16:05
GIULIANI, GIAN CARLO	SOME SHELLS BUILT IN ITALY	16:05	16:25
GIULIANI, GIAN CARLO	HEAVY DUTY LARGE SPAN PRECAST FLOORS	16:25	16:45
<b>SUSTAINABLE STRUCTURES --- HOSKERE V. &amp; MONTICELLI C. ROOM =C= AND =D=</b>		<b>APRIL 6TH</b>	
MONTICELLI		9:25	9:45
INADA, TATSUO	STUDY ON THE WAY OF BUILDING CONSTRUCTION IN SUSTAINABLE SOCIETY	9:45	10:05
ANANTHARAMAN, SRINIDHI	SUSTAINABLE PROCESSES IN STEEL CONSTRUCTION	10:05	10:25
OBREBSKI, MICHAL	RISK MANAGEMENT FOR INVESTMENT IN COMMERCIAL OBJECTS	10:25	10:45
MURTHY, ABHISHEK	GROWING BUILDINGS - WITH EXAMPLES OF AMARA HOTEL & SHOPPING CENTRE AND ABDUL GAFOOR MOSQUE	10:45	11:05

**SUSTAINABLE STRUCTURES --- HOSKERE V. & MONTICELLI C. ROOM =C= AND =D=**

**APRIL 6TH**

HOJO, TOSHIO	A STUDY ON STRENGTHENING OF EXISTING RC BEAM -FOR REUSE OF UNDERGROUND STRUCTURE-	11:30	11:50
MIRCEA, ANDREEA-TEREZIA	THE ENVIRONMENTAL DEMAND FOR EFFICIENT RECYCLING OF MATERIALS FROM DEMOLITION SITES	11:50	12:10
ROSANI, DIEGO	HIGH PERFORMANCE CONCRETE FOR SUSTAINABLE CONSTRUCTION	12:10	12:30
KOKAWA, TSUTOMU	ICE SHELL CONSTRUCTION IN HOKKAIDO	12:30	12:50

**TESTS --- TOMAŽEVIC M. ROOM =C=**

**APRIL 6TH**

TOMAŽEVIC, MIHA	SEISMIC STRENGTHENING OF BRICK MASONRY WALLS WITH COMPOSITES: AN EXPERIMENTAL STUDY	11:30	11:50
FONT, ALEXANDER	THE USE OF PIEZOELECTRIC TRANSDUCERS AND FIBER OPTIC SENSORS IN STRUCTURAL HEALTH MONITORING OF CONCRETE STRUCTURES: A STATE OF THE ART	11:50	12:10
MANTEGAZZA, DAVIDE	IN SITU CONCRETE STRENGTH TESTING BY NON-DESTRUCTIVE COMBINED METHODS WITH ONE, TWO AND THREE VARIABLES (REBOUND NUMBER, ULTRASONIC PULSE VELOCITY, WINDSOR PROBE)	12:10	12:30
PAN, HUANG-HSING	DETERMINATION OF INTERFACIAL TRANSITION ZONE IN CEMENTITIOUS MATERIALS BY DYNAMIC DISPLACEMENT	12:30	12:50
GENTILE, C.	DYNAMIC ASSESSMENT AND HEALTH MONITORING OF AN HISTORIC IRON ARCH BRIDGE	12:50	13:10
RICCI, ILARIA	SQUAT CONCRETE WALLS: RESULTS OF PSEUDO-STATIC TESTS WITH CYCLIC HORIZONTAL LOAD ON CAST IN SITU SANDWICH PANELS	15:05	15:25
HOU, TSUNG-CHIN	COMPARISON OF ELECTRODE INSTRUMENTATIONS FOR ELECTRICAL MEASUREMENT OF CEMENT-BASED MATERIALS	15:25	15:45
CICCHIELLO, PIERPAOLO	H/V PASSIVE INVERSION TECHNIQUES AND METAPROJECTUAL DECISIONS	15:45	16:05